

THIS INFORMATION CONTAINED IN THIS DRAWING IS THE SOLE PROPERTY OF C&M WOOD INDUSTRIES, INC. ANY REPRODUCTION IN PART OR AS A WHOLE WITHOUT THE WRITTEN PERMISSION OF C&M WOOD INDUSTRIES, INC. IS PROHIBITED.

REV.	DESCRIPTION	DATE	DRAWN BY	APPROVED
01	INITIAL RELEASE	15/03/06	Thien	Hugo
$\triangle$ 02	CHANGE 3.52" TO 3.38"	27/11/06	Thien	BP

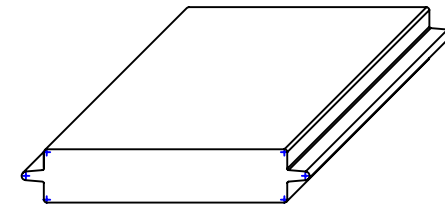
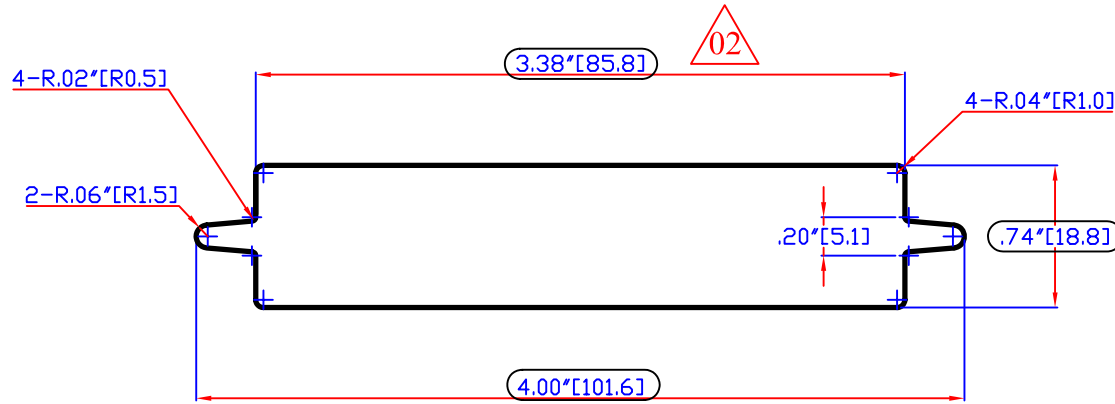

**NOTES:**

1. ALL DIMENSIONS ARE FINISHED DIMENSIONS UNLESS OTHERWISE SPECIFIED.
2. BREAK ALL SHARP EDGES.
3. FINISH: SURFACE FINISH SHALL BE NO SCRATCH, SCAR OR DENT AND NO PATCH IN COLOR.
4. **(CIRCLED)** DIMENSIONS ARE CRITICAL DIMENSIONS.

TOLERANCES UNLESS OTHERWISE SPECIFIED			SCALE 1:1	NAME	DATE	C&M WOOD INDUSTRIES, INC.
SYMBOL	METRIC	ENGLISH	DRAWN BY	Thien	25/09/06	
.X / .XX	± .3	± .01	CHECKED	Thien	25/09/06	DESCRIPTION <b>R9AJ - RAIL DIVIDER BEADED (RAW WOOD)</b>
.XX/.XXX	± .13	± .005				
ANGLE	± 2°	± 2°	APPROVED	BP	27/11/06	
	[MM]	INCH				DWG.NO. <b>VS253</b>
MOISTURE: 6% - 10%		MATERIAL: BY CUSTOMER		ENGINEERING CODE		REV. <b>02</b> CUSTOMER:
		COLOR: BY CUSTOMER				